

Bronze Globe Valve for Cryogenic Service

202X Series Including 206LL, 206GF, 206ULL, 206BLL

Features

- Top Entry: This union bonnet valve can be permanently installed in the line and serviced from the top
- Construction: Rugged construction for long life, bronze cast body and bonnet
- Designed with the unique Kold-Seal™ and high CV. Standard PCTFE seat design assures bubble tight seating and high cycle life
- Sizes: ¼" through 2" (8mm through 50mm)
- Ends: Threaded (FNPT), Sil Braze Tube (SBT), or with stainless steel pipe nipples brazed in
- Service: Liquefied and vaporized atmospheric gases, LNG
- Temperature Rating: -320°F to 150°F (-196°C to +65°C)
- Pressure Rating: (Cold, Non-shock)
202 Series Rated for 400 psig (28 barg)
206 Series Rated for 600 psig (42 barg)
Sizes 1.5" to 2.0" PED approved per EN10204, 3.1
- Kold-Seal™ Technology assures tight seal preventing cryogen gas loss. Non-extended stem for selective cold gas service.
- Cleaned for Oxygen Service per CGA G-4.1



206ULL



206BLL

Ordering Information

202X
Bronze Globe Valves
Non-Extended Stem - Conical Seat
400 psig (28 barg) Cold Working Pressure
For selective Cold Gas Applications

Threaded End

Part Number	NPT Valve size Inches	NPT Valve Size DN	Ends	Weight Lbs.	Weight Kg	Estimated Cv (Kv)
B-202X-12T4	1½"	40	Threaded	6.50	3.00	29.00 (25.08)
B-202X-16T4	2"	50		10.50	4.80	50.00 (43.25)

Sil Braze Ends

Part Number	SBT Valve size Inches *	SBT Valve Size DN *	Ends	Weight Lbs.	Weight Kg	Estimated Cv (Kv)
B-202X-4S4	½"	15	Silver Braze	1.50	0.7	3.90 (3.37)
B-202X-8S4	1"	25		3.25	1.50	11.50 (9.94)
B-202X-12S4	1½"	40		6.50	3.00	29.00 (25.08)
B-202X-16S4	2"	50		10.50	4.80	50.00 (43.25)

* Nominal Size

Bronze Globe Valve for Cryogenic Service

202X Series Including 206LL, 206GF, 206ULL, 206BLL

206GF

Bronze Globe Valves

Non-Extended Stem - PFA seat with high temperature, low permeability GRAFOIL® packing and gasket.

600 psig (42 barg) Cold Working Pressure, For Selective Cold Gas Applications, High Temperature Service Rating +350°F (+176°C)

Threaded Ends

Part Number	NPT Valve size Inches	NPT Valve Size DN	Ends	Weight Lbs.	Weight Kgs.	Estimated Cv (KV)
VB-206GF-2T6	¼"	8	Threaded	1.25	0.6	1.30 (1.12)
VB-206GF-4T6	½"	15		1.50	0.7	3.90 (3.37)
VB-206GF-6T6	¾"	20		2.50	1.1	7.10 (6.14)
VB-206GF-8T6	1"	25		3.50	1.6	11.50 (9.94)
VB-206GF-12T6	1½"	40		7.00	3.2	29.00 (25.08)
VB-206GF-16T6	2"	50		11.75	5.3	50.00 (43.25)

206LL

Bronze Globe Valves, Non-Extended Stem, Live Loaded Packing, 600 psig (42 barg) Cold Working Pressure

For Selective Cold Gas Applications

Threaded Ends

Part Number	NPT Valve size Inches	NPT Valve Size DN	Ends	Weight Lbs.	Weight Kgs.	Estimated Cv (Kv)
B-206LL-2T6	¼"	8	¼" NPT	1.25	0.6	1.30 (1.12)
B-206LL-3T6	⅜"	10	⅜" NPT			2.40 (2.07)
B-206LL-4T6	½"	15	½" NPT	1.75	0.8	3.90 (3.37)
B-206LL-6T6	¾"	20	¾" NPT	2.5	1.1	7.10 (6.14)
B-206LL-8T6	1"	25	1" NPT	3.5	1.6	11.50 (9.94)

Sil Brazed Ends

Part Number	SBT Valve size Inches *	SBT Valve Size DN	Ends	Weight Lbs.	Weight Kgs.	Estimated Cv (Kv)
B-206LL-4S6	½"	10	Silver Braze	1.25	0.6	3.90 (3.37)
B-206LL-6S6	¾"	15		1.75	0.8	7.10 (6.14)
B-206LL-8S6	1"	20		2.5	1.1	11.50 (9.94)

* Nominal Size

206ULL

Bronze Globe Valves, Non-Extended Stem, Live Loaded Packing - Union Bonnet,

600 psig (42 barg) Cold Working Pressure For Selective Cold Gas Applications

Sil Brazed Ends

Part Number	SBT Valve size Inches	SBT Valve Size DN	Ends	Weight Lbs.	Weight Kgs.	Estimated Cv (Kv)
B-206ULL-12S6	1½"	40	Silver Braze	7	3.2	29.00 (25.08)
B-206ULL-16S6	2"	50		11.75	5.3	50.00 (43.25)
B-206ULL-12T6	1½"	40	1½" NPT	7	3.2	29.00 (25.08)
B-206ULL-16T6	2"	50	2" NPT	11.75	5.3	50.00 (43.25)

206BLL

Bronze Globe Valves, Non-Extended Stem, Live Loaded Packing - Bolted Bonnet,

600 psig (42 barg) Cold Working Pressure For Selective Cold Gas Applications

Sil Brazed Ends

Part Number	SBT Valve size Inches	SBT Valve Size DN	Ends	Weight Lbs.	Weight Kgs.	Estimated Cv (Kv)
B-206BLL-12S6	1½"	40	Silver Braze	7	3.2	29.00 (25.08)
B-206BLL-12T6			1½" NPT			

Bronze Globe Valve for Cryogenic Service

202X Series Including 206LL, 206GF, 206ULL, 206BLL

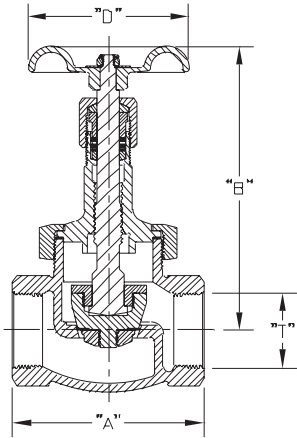

202 Series

202X

Pressure Rating 400 psig (28 barg)
 Temperature Rating -325°F to +150°F (-198°C to +65°C)
 Non-Extended Valve for Cold Gas Applications
 Conical Seat

Dimensional data

All Dimensional Data are in inches.

Threaded Ends

Size		"A"		"B"		"D"		"T" NPT	
Inches	DN	Inches	mm	Inches	mm	Inches	mm	Inches	mm
1½"	40	4¾"	121	8⅝"	219	4"	102	1½"	38
2"	50	5¾"	146	9½"	241	4¾"	121	2"	51

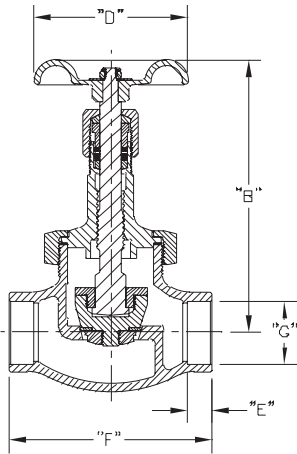

Silver Brazed Ends

Size		"B"		"D"		"E"		"F"		"G"	
Inches	DN	Inches	mm	Inches	mm	Inches	mm	Inches	mm	Inches	mm
½"	15	4⅝"	117	2"	51	.38	10	3¼"	82	0.63	16
1"	25					.44	11	4¼"	108	1.19	30
1½"	40	5"	127	2⅝"	60	.62	16	5¼"	133	1.63	41
2"	50	5¾"	146	2¾"	70	.66	17	6½"	159	2.13	54

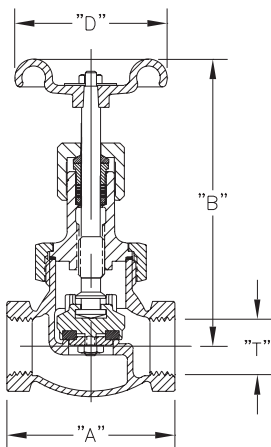

206GF

Pressure Rating 600 psig (42 barg)
 Temperature Rating -325°F to +350°F (-198°C to +22°C)
 Non-Extended Stem - GRAFOIL® Packing, Gasket and PFA Seat

Dimensional data

All Dimensional Data are in inches.

Threaded Ends

Size		"A"		"B"		"D"		"T" NPT	
Inches	DN	Inches	mm	Inches	mm	Inches	mm	Inches	mm
¼"	8	2⅝"	67	4⅝"	117	2"	51	¼"	6
½"	15			5"	127	2⅝"	60	½"	13
¾"	20	3⅜"	81	5¾"	146	2¾"	70	¾"	19
1"	25	3¾"	95	6¾"	171	3"	76	1"	25
1½"	40	4¾"	121	8⅝"	219	4"	102	1½"	38
2"	50	5¾"	146	9½"	241	4¾"	121	2"	51

Bronze Globe Valve for Cryogenic Service

202X Series Including 206LL, 206GF, 206ULL, 206BLL

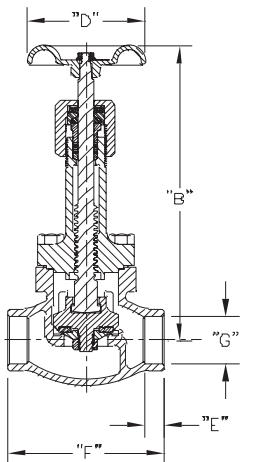
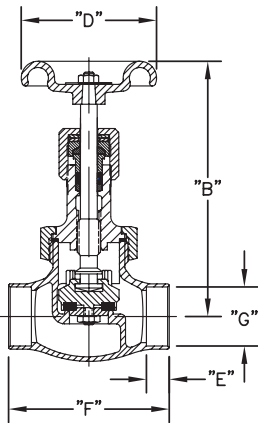
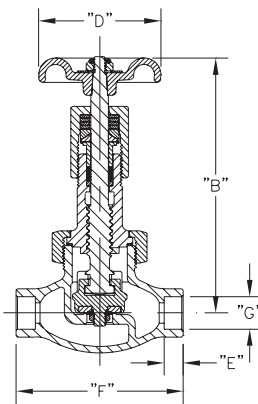
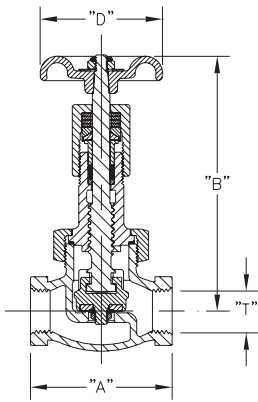

206LL

Pressure Rating 600 psig (42 barg)
 Temperature Rating +150° F to -325° F (+65°C to -198°C)
 Live Load Packing
 Union Bonnet

Dimensional Data

Threaded Ends

Size		"A"		"B"		"D"		"T" NPT	
Inches	DN	Inches	mm	Inches	mm	Inches	mm	Inches	mm
1/4"	8	2 5/8"	67	5"	127	2 3/8"	60	1/4"	6
3/8"	10							3/8"	9
1/2"	15							1/2"	13
3/4"	20	3 3/16"	81	5 3/4"	146	2 3/4"	70	3/4"	19
1"	25	3 3/4"	95			3"	76	1"	25

Sil Brazed Ends

Size		"B"		"D"		"G"		"E"		"F"	
Inches	DN	Inches	mm	Inches	mm	Inches	mm	Inches	mm	Inches	mm
1/4"	8	5"	127	2 3/8"	60	0.36	10	.26	7	2 3/8"	60
1/2"	15					0.63	16	.38	10	3 1/4"	82
1"	25	6 3/4"	171	3"	76	1.13	29	.44	11	4 1/4"	108

206ULL

Pressure Rating 600 psig (42 barg)
 Temperature Rating +150° F to -325° F (+65°C to -198°C)
 Live Load Packing - Union Bonnet

Dimensional Data

Sil Brazed Ends

Size		"F"		"B"		"D"		"T" NPT	
Inches	DN	Inches	mm	Inches	mm	Inches	mm	Inches	mm
1 1/2"	40	4 3/4"	121	8 5/8"	219	4"	102	1 1/2"	38
2"	50	5 3/4"	146	11 1/4"	298	4 3/4"	121	2"	51

206BLL

Pressure Rating 600 psig (42 barg)
 Temperature Rating +150°F to -325°F (+65°C to -198°C)
 Live Load Packing - Bolted Bonnet

Dimensional Data

Sil Brazed Ends

Size		"B"		"D"		"G"		"E"		"F"	
Inches	DN	Inches	mm	Inches	mm	Inches	mm	Inches	mm	Inches	mm
1 1/2"	40	8 5/8"	219	4"	102	1.62/1.64	41/42	.63	16	5 1/4"	133