

Brass Pipe & Pipe Nipples

Heavy-duty, yellow brass pipe and pipe nipples are designed with a high quality, seamless thick wall construction. They are suitable for use in most industrial piping applications.

ASTM B135 Alloy 330

½" I.D. pipe, O.D. is 0.840".

¾" I.D. pipe, O.D. is 1.050".

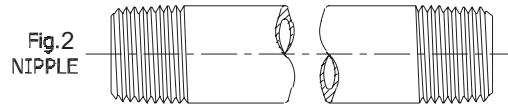
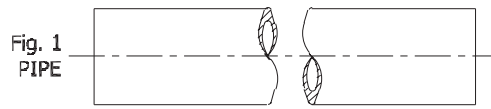

Ordering Information

Part Number	Figure	Inside Diameter		Inlet / Outlet Connections (M.NPT)		Length		Maximum Operating Pressure*		
		Inches	mm	Inches	mm	Inches	mm			
TNE1050-14400	1	½"	13	Not Available	-	12 Feet	3657	3600 psig (248.2 barg)		
TNE1075-14400		¾"	19							
1025-15	2	½"	13	½"	13	¼"	6		1.44"	37
1050-10						1.13"	29			
1050-15						1.5"	38			
1050-20						2"	51			
1050-25						2.5"	63			
1050-40						4"	102			
1050-60		6"	152							
1050-80		8"	203							
1075-20		¾"	19	¾"	19	2"	51		3"	76
1075-30						4"	102			
1075-40	5"					127				
1075-50	6"					152				

Brass Elbows

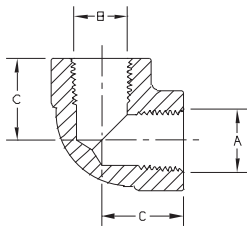

Fig. 1

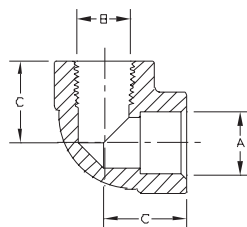

Fig. 2

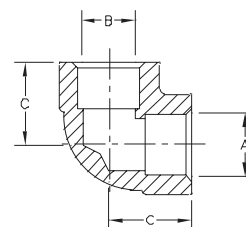

Fig. 3



Ordering Information

Part Number	Figure	A (Female)		B (Female)		C (Ref.)		Working Pressure
		Inches	mm	Inches	mm	Inches	mm	
1228-1	1	½" NPT	13	½" NPT	13	1 ⅛"	28	3750 psig (258.7 barg)
HP1228-1		¾" NPT	19	¾" NPT	19	1 ½"	38	4500 psig (310.5 barg)
1043								
1228-2	2	½" NPT	13	.843-.847	21-22	1 ⅛"	28	3750 psig (258.7 barg)
HP1228-2		¾" NPT	19	1.053-1.057	27	1 ½"	38	4500 psig (310.5 barg)
2223-2	3	.843-.847	21-22	.843-.847	21-22	1 ⅛"	28	3750 psig (258.7 barg)
1228-4						1 ½"	38	6000 psig (414 barg)
HP1228-4								4500 psig (310.5 barg)
2233-6		1.053-1.057	27	1.053-1.057	27			4500 psig (310.5 barg)

*Safety factor = 4:1