

Connector for DOT Cylinder Filling Adapter 7193T-10

Application

The 7193T-10 Connector is designed for use on the 7193D-10 Filling Adapters. Connector allows quick connection to the Type I 1^{5/16}" M. ACME threads for operators that fill both POL and Type I valves.



7193T-10

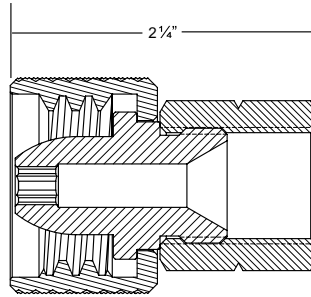

Ordering Information

Part Number	Applications	Inlet Connection	Outlet Connection	Materials
7193T-10	Converts 7193D-10 Adapters from POL to a Type 1 Connection	F. POL CGA 510	Type 1 Connection (1 ^{5/16} " F. ACME)	Brass

J